

WITH 5-YEAR WARRANTY

Owner's Manual

Marlin[®]

SELF-LOADING

Rifle (22 L.R. only)

With Tubular Magazine

IMPORTANT

This manual contains operating, care and maintenance instructions. To assure safe operation, any user of this firearm must read this manual carefully. Failure to follow the instructions and warnings in this manual can cause accidents resulting in injury or death. This manual should always accompany this firearm, and be transferred with it upon change of ownership.

The warranty card attached to the cover must be filled out and mailed within 10 days of purchase.

WARNING: KEEP THIS FIREARM OUT OF THE REACH OF CHILDREN, UNAUTHORIZED INDIVIDUALS, AND OTHERS UNFAMILIAR WITH THE SAFE HANDLING OF FIREARMS.

LIMITED WARRANTY AND CERTIFICATE OF OWNERSHIP

To insure warranty protection, this card must be completed and mailed within 10 days of purchase.

Model _____ **Date of Purchase** _____
Serial Number _____

I have read the Owner's Manual and request registration of my warranty. _____
(signature of owner)

Please Print

Owner _____ **Address** _____

City _____ **State** _____ **Zip Code** _____

e-mail _____

Name of Store where purchased _____ **City** _____ **State** _____

To help us provide new and better products we would appreciate your answers to the following questions.

Your Occupation

- Farm
- Student
- Office
- Industrial
- Professional
- Managerial

Your Age Group

- Under 18
- 18-24
- 25-34
- 35-49
- 50+

Which of these influenced your purchase?

- Previous experience with product
- Brand reputation
- Marlin web site
- Marlin advertisement
- Marlin catalog

Was this product a gift?

- Yes
- No

LIMITED WARRANTY
The Marlin Firearms Company
**FIVE YEAR LIMITED WARRANTY AGAINST
DEFECTS IN MATERIAL & WORKMANSHIP**

This firearm warranty is good only to the ORIGINAL OWNER who has registered his ownership with The Marlin Firearms Company at 100 Kenna Drive, North Haven, Connecticut.

WARRANTY and CERTIFICATE OF OWNERSHIP card **must** be completed and mailed to The Marlin Firearms Company at the above address WITHIN TEN (10) DAYS of purchase to insure the protection of the warranty. NOTICE of defect in materials and/or workmanship **must** be received by the company WITHIN FIVE (5) YEARS from the date of purchase.

Normal wear, or damage resulting from neglect, abuse, alteration, or repairs not made or authorized by The Marlin Firearms Company or use of non-Marlin parts are not covered by the warranty.

THIS WARRANTY GIVES YOU SPECIFIC LEGAL RIGHTS, AND YOU MAY ALSO HAVE OTHER RIGHTS WHICH VARY FROM STATE TO STATE.

**MARLIN'S PERFORMANCE UNDER
THE ABOVE WARRANTY**

1. After notice of defect in material and/or workmanship is received by The Marlin Firearms Company, Marlin shall send instructions for shipment of the firearm; and repairs will be made and the firearm returned within a reasonable time after the firearm is received. Cost of shipping, insurance charges, etc. involved in returning the firearm to the company shall be prepaid by the original owner.
2. Cost of parts and labor performed shall be provided without charge by The Marlin Firearms Company.
3. If The Marlin Firearms Company, after receipt of the firearm, determines that the defects in material and/or workmanship were the result of abuse and/or neglect, or otherwise not covered by the warranty set forth above, Marlin shall notify such owner to that effect and give an estimate for repair. In such cases, repair, return shipping and insurance charges, etc. shall be paid by such owner.
4. In the event that The Marlin Firearms Company is unable to make warranty repairs to the firearm, it shall, within a reasonable time after its receipt, notify the owner to that effect and give him the option either to receive a replacement of the same model, if then available in its inventory, or to receive a refund, either of which, if feasible, will be made through the store of purchase.

The Marlin Firearms Company
100 Kenna Drive, North Haven, CT 06473-0905
www.marlinfirearms.com

PLACE
STAMP
HERE



MFC
P.O. Box 248
North Haven, CT 06473-0903



Before You Use This Firearm

It is very important that you read and understand this manual before using this firearm. Warnings should be read and heeded carefully. Also follow "Marlin's Guide to Gun Safety" in this manual.

- **WARNING:** Marlin firearms are designed and manufactured to handle standard factory-loaded ammunition which conforms to SAAMI (Sporting Arms and Ammunition Manufacturers' Institute Inc.) standards with dependability and safety. Due to the many bullet and load options available, the element of judgement involved, the skill required, and the fact that serious injuries have resulted from dangerous handloads, Marlin does not make any recommendations with regard to handloaded ammunition.
- **WARNING:** Your rifle is shipped completely assembled and should not be used or disassembled without fully reading and understanding the instructions in this Owner's Manual.
- **WARNING:** It is a violation of federal law to alter or deface the serial number of any firearm.

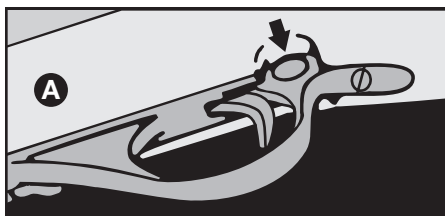

SAFE Position

How to Operate the Safety

- **WARNING:** Prior to firing, become familiar with the operation of the safety by practicing with the rifle unloaded.

The safety mechanism is a round button located behind the trigger. To put your rifle on SAFE, hold it in the normal shooting position, pointed in a safe direction, and push the safety button from left to right as far as it will go. The safety is now on SAFE (See A).

To move the safety to the FIRE position, push the safety button from right to left as

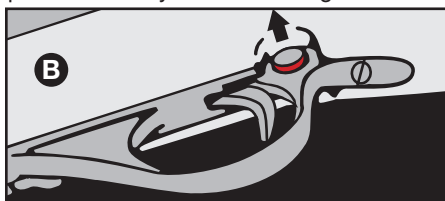

FIRE (Off Safe) Position

far as it will go. A red ring around the safety button will be visible when the safety is in the FIRE position (See B). If the trigger is pulled with the safety in this position, the gun will fire.

- **WARNING:** Never disassemble the safety. It has been correctly designed, fitted and tested, and is not reversible. Any mechanical device can fail, however, so never rely on the safety to justify careless handling. Never use a firearm with a safety that does not function properly. (See instructions for factory maintenance in this manual.)

Bolt Hold-Open Features

Automatic "Last Shot" Bolt Hold-Open Feature

This safety feature is activated when the last shot in the rifle has been fired (i.e.

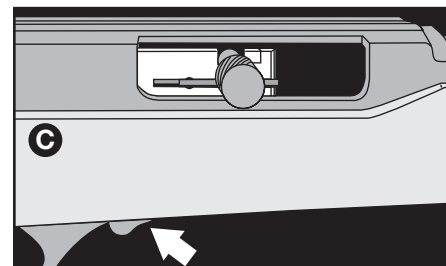

Press to release automatic bolt hold-open

when the magazine, feedthroat, and chamber are empty). The bolt will stop about half way to the open position (See C). With the bolt in this position, you should visually check to be sure that the chamber is empty and the orange magazine follower is visible in the feedthroat, indicating that the magazine is empty. To close the bolt completely, with the safety on SAFE, and the gun empty, press the bolt release lever in the front of the trigger guard (See C). As long as the magazine remains empty, the automatic bolt hold-open will engage each time the bolt is pulled all the way back.

Manual Bolt Hold-Open Feature

In addition to the automatic “last shot” bolt hold-open, which stops the bolt about half way back, the bolt can also be manually locked in the fully open position. This device makes it easy to clean the chamber, feedthroat and bore.

First, with the chamber and magazine empty, pull the charging handle all the way back, and hold it. Now engage the lock by pushing the charging handle to the left, in the direction of the arrow on the back of the handle (See D & E).



Locking the action open manually



Unlocking the action manually

To close the action, pull the charging handle out to the right and let it snap forward (See E1). Then press the bolt release lever in front of the trigger guard to completely close the bolt.

- **WARNING:** Releasing the manual bolt hold-open while the inner magazine is locked in place and there are cartridges in the feeding system, will close the bolt and chamber a cartridge.
- **WARNING:** When not in use, the safest possible way to handle your rifle is com-

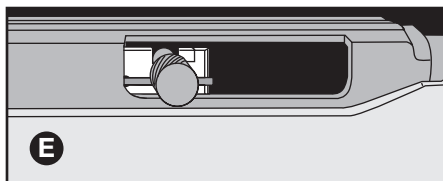

Action locked fully open

pletely unloaded, with the action open, the safety on SAFE, and pointed in a safe direction.

How to Load

- **WARNING:** Never attempt to load your rifle with ammunition that does not meet the cartridge designation stamped on the barrel. Use only clean, dry, factory-loaded ammunition which conforms to industry standards.
- **WARNING:** Your rifle is a self-loading .22 caliber designed for .22 Long Rifle High Velocity cartridges only (not Hyper-Velocity). Shorts, Longs, and Shot cartridges can be loaded and fired, but Marlin does not recommend them, as feeding will not be reliable and damage or injury may result from their use.

- **WARNING:** Before loading your rifle, always check the bore and chamber to be sure they are free of grease, oil or any other obstruction.
- **WARNING:** This rifle will not function properly unless the inner magazine tube is locked securely in place.
- **WARNING:** Never add cartridges to a partially loaded tubular magazine.
- **WARNING:** The following procedure is the only recommended method of loading.

Be sure the chamber is empty, the safety is on SAFE, the bolt is in the “last shot” automatic hold-open position, and the rifle is pointed in a safe direction.

To load the magazine, turn the rifle upside down and, keeping your fingers away from the muzzle, unlock the inside magazine tube by turning the knurled locking end plug (See F). Extract the inside tube from the outside tube until the loading port is exposed (See G).



Unlocking the magazine

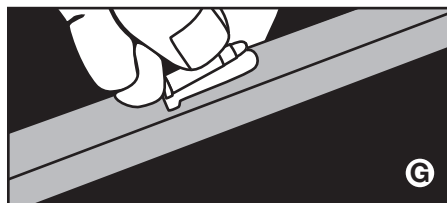

Loading the magazine

With the muzzle raised, drop Long Rifle cartridges into the loading port, bullet end toward the muzzle (See G). When you have loaded up to 14 cartridges, slide the tube back in place, turning it slightly to ease passage over the loaded rounds. **DO NOT FORCE THE TUBE DOWN.** Then rotate the knurled locking end plug to the locked position.

The inner tube will not lock in place if the number of cartridges loaded exceeds the stated magazine capacity.

- **WARNING:** Your rifle is not designed to be single-loaded. Always load cartridges through the magazine as directed above.

With the safety on SAFE and the rifle pointed in a safe direction, close the bolt by pressing the bolt release lever in front of the trigger guard (See C). This should close the bolt on an empty chamber. Now, to chamber a cartridge, you must pull the

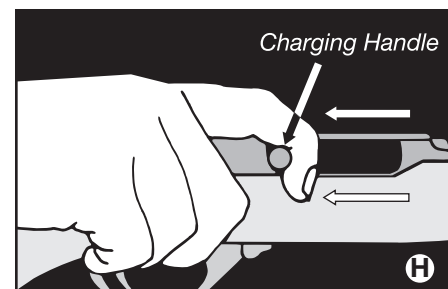

Pull charging handle all the way back

charging handle *all the way back* and let the bolt snap forward again (See H & I).

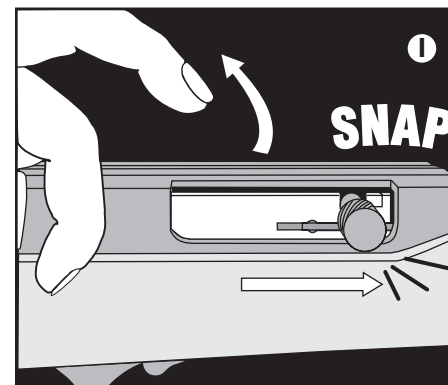

Let it snap forward

- **WARNING:** Your rifle is now cocked and ready to fire as soon as the safety is pushed to the FIRE position.

How to Fire

Push the safety to the “FIRE” position and, with the rifle pointed at the target, squeeze the trigger. Since your rifle is self-loading, after each shot it is ready to be fired again, until the magazine, feedthroat, and chamber are empty, at which point the automatic “last shot” bolt hold-open will engage.

If you do not fire all cartridges in the magazine, be sure to put the safety on “SAFE” until you are ready to shoot again.

- **WARNING:** Because of its self-loading action, if the bolt of your rifle is completely closed, you must assume that it is cocked and loaded.

How to Unload

- **WARNING:** Before you unload, be sure your rifle is on SAFE and pointed in a safe direction, and that your fingers are away from the muzzle and the trigger.

Be *sure* the inner magazine tube is locked in place. Cycle the action repeatedly by pulling the charging handle all the way back and letting it snap forward (See J).

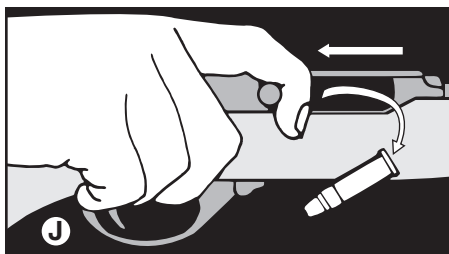

Unloading

Repeat this action until the ejection of cartridges ceases. When the last cartridge has been ejected, the automatic bolt hold-open will engage (See C).

Any mechanical device can fail, so ALWAYS CHECK THE CHAMBER AND FEEDTHROAT VISUALLY TO BE SURE NO CARTRIDGES REMAIN. The orange magazine follower is visible in the feedthroat when the magazine is empty.

What to do if your Rifle Fails to Fire

1. Misfire. If you have squeezed the trigger and nothing happens, remain in shooting position, pointing the gun in a safe direction. Count to 10, then unload the rifle completely (See “How to Unload”).

2. Underpowered shot. A “squib” or underpowered shot, should not occur if the ammunition is clean, dry, and factory loaded. You can tell if a shot is underpowered by the unusually low sound it makes.

- **WARNING:** Because the bullet may actually still be in the barrel, you must unload completely, and determine, with a cleaning rod, if there is an obstruction. If there is, it should be removed by a qualified gunsmith. Otherwise, personal injury or damage could result.

Sighting

Your rifle has been sighted-in and test-fired at the factory. Due to individual shooting characteristics, however, sighting should be range verified.

1.) Vertical Correction (Elevation)

To raise the point of impact, raise the rear sight, by moving the sight elevator rearward. To lower the point of impact, lower the rear sight, by moving the sight elevator forward. The sight can be raised and lowered by moving the stepped elevator forward and back with your thumb.

2.) Horizontal Correction (Windage)

To move the point of impact to the left, tap the rear sight base to the left. To move the point of impact to the right, tap the rear sight base to the right.

Windage adjustments to the rear sight can be made by gently tapping the dovetail portion of the rear sight in the desired direction.

Scope Mounting

Your rifle has a grooved receiver designed to handle tip-off-type 22 scope bases. They are made by Tasco, Weaver, and others, and are available through your local gun dealer. You may also order directly from Marlin Gun Service. Call 1-800-544-8892 for more information.

How to Clean Your Rifle

• **WARNING:** Never attempt to wipe down or clean a loaded firearm. Follow instructions under "How to Unload" before cleaning.

Caution: Before using any solvent or other gun cleaning product, read the label carefully to be sure it will not damage either the finish, or any parts of this firearm.

NOTE for stainless steel models: Although stainless steel is corrosion-resistant, it can rust. If the rifle gets wet, dirty, or

is subject to excessive handling, wipe down metal parts with oil or a rust-inhibitor.

Minor scratches can be "buffed out" of stainless steel with a "Scotch-Brite™ Very Fine" pad, available in hardware and automotive supply stores.

Cleaning the Bore

Since modern ammunition burns very cleanly, with normal use it is not necessary to clean the bore of your rifle. However, if it gets wet, or if any foreign material gets into the action or barrel, cleaning as described below is recommended.

With the safety on SAFE, visually check the chamber and feedthroat to be sure no cartridges remain in the rifle. The orange magazine follower should appear in the feedthroat. Next, pull the charging handle all the way back and lock in the manual hold-open position.

To clean the bore and barrel, use any standard .22 caliber commercial cleaning rod and cleaning patches. Clean the barrel with powder solvent and wipe lightly with gun oil after cleaning.

Cleaning the Action

We recommend that you wear safety glasses while disassembling this rifle.

We recommend cleaning the inside of the receiver, bolt face, extractors, and butt end of the barrel (around the chamber) after firing each 250 rounds. (Frequency of cleaning may depend on brand of ammunition used.) A toothbrush and commercial gun cleaning solvent will simplify the job. (Be sure to follow manufacturer of gun cleaner's directions, as some chemicals may damage the synthetic trigger guard.)

The steps listed below should be followed carefully to assure proper disassembly, cleaning and reassembly.

Step #1 — With the safety on SAFE and the inner magazine tube locked in place, unload the gun and visually check to be doubly sure no cartridges remain. Then close the action completely.

Step #2 — The inner magazine tube should be removed in accordance with the procedure described under "How to Load".

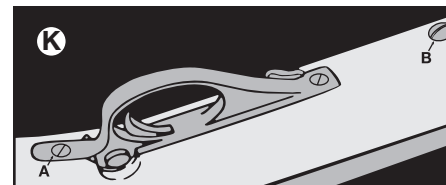

Remove takedown screws



Remove assembly post

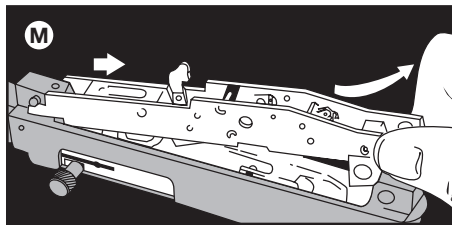

Remove action

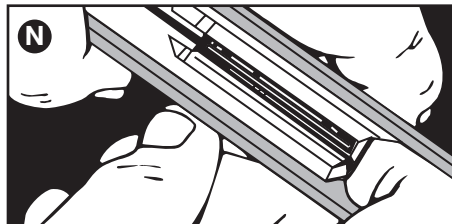

Lift muzzle end of breech bolt from receiver

Step #3 — Unscrew takedown screws A and B as shown in K. Separate the rifle into two segments, the first consisting of the stock and trigger assembly, the second consisting of the barrel and action.

Release assembly post by squeezing and pushing in slotted end. Pull post free of action (See L). Remove action by sliding it to the rear and up (See M).

Step #4 — With the action removed, the bolt, charging handle, recoil spring and spring guide may now be removed.

•**WARNING: Recoil spring is compressed at this point and, if not handled properly, can fly from the receiver.**

Pull the charging handle back slightly and, with the forefinger of your other hand, lift the muzzle end of the bolt from the receiver (See N).

As you begin to lift the bolt out, the charging handle will become free and can be removed. The recoil spring and spring guide are now within easy reach for removal (See O).

Step #5 — The barrel, receiver and action are now ready for thorough cleaning. The action should be cleaned in solvent, dried, and oiled sparingly prior to reassembly.

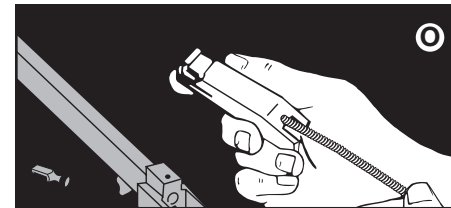

Remove charging handle, recoil spring and spring guide

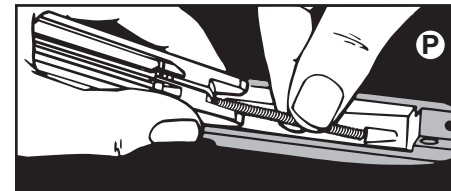

Support recoil spring to prevent kinking

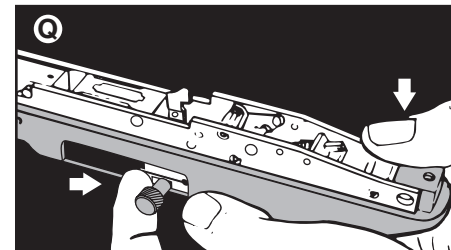

Pull charging handle back to replace action

Further disassembly of the action is not recommended and should only be attempted by a qualified gunsmith or the factory.

Step #6 — (Reassembly is easier if gun is secured in a padded vise, or held by an assistant.) To reassemble, place recoil spring guide into one end of recoil spring, then place opposite end of spring into breech bolt. Next, put recoil spring guide into hole at the rear of the receiver. To prevent kinking the spring, hold breech bolt and recoil spring in one hand and use the other hand to support the spring as shown in P, while compressing spring until guide enters breech bolt.

Step #7 — The charging handle can now be positioned through the ejection port. To complete the insertion of the breech bolt, be sure the charging handle fits into the slot provided for it in the bolt.

Reinstall the action by pulling the charging handle all the way back and locking it in the open position, and reversing the action disassembly procedure (See Q).

When reassembling the barreled action and stock, be sure the receiver is seated as far *back* in the stock as it will go while tightening the takedown screw. Otherwise, the rifle may not fire.

Use a very thin coat of light oil during below freezing conditions. Condensation droplets will form soon after the rifle is brought into a warm room, or it may become wet during inclement weather. In any case, all moisture should be removed. Exterior metal finishes may be wiped down with a lightly oiled cloth. For long term storage, lightly oil the bore, barrel and action with gun oil. Your gun should be completely unloaded and stored in a dry area with the action open. Never store your gun in a carrying case.

Repair Instructions

Your firearm has been designed, engineered and manufactured in accordance with Marlin's rigid quality control standards. However, any mechanical device may occasionally require adjustment or repair.

Questions regarding the performance and serviceability of your firearm should be addressed to Marlin Gun Service. You should include the Serial Number, Model Number and a full description of the conditions and problems involved.

Warranty Repairs

Our Warranty policy covers all our firearms against defects in workmanship or material for a period of five years from the date of

purchase to the original owner. See the inside front cover of this manual for warranty details.

Guns requiring warranty repairs should be returned to the factory. Be sure to follow the "Shipping and Handling" instructions on this page.

Non-Warranty Repairs

A competent gunsmith may be able to repair your gun. If not, ship it to the factory, following the "Shipping and Handling" instructions on this page.

After receiving your firearm, we will send you an estimate of the repair cost. Repairs will begin upon receipt of your check or money order. If repairs are not possible, your firearm will be returned.

Shipping and Handling

When sending your firearm to the factory please follow these instructions:

1. Prior to shipping, be absolutely certain that the firearm is completely unloaded (See "How to Unload" in this manual).
2. Pack your firearm carefully. Use ample cushioning material and a sturdy outer cardboard box. Do not ship in a special container which you want returned.

3. Accessories such as scopes, scope mounts, gun case, quick-detach type swivels, slings, etc. should be removed prior to returning the firearm.

4. Inside the box, include the following information: model number, serial number, description of damage or problem, and under what conditions problem occurs.

5. Keep a record of your serial number when returning a firearm.

6. Clearly mark your return address on the outside of the box and on your instruction sheet.

7. Do not ship live ammunition under any circumstances.

8. Ship your firearm via insured Parcel Post or U.P.S. Shipment must be prepaid and addressed to:

**MFC INC.
ATTN: SERVICE DEPT.
100 KENNA DRIVE
NORTH HAVEN, CONN. 06473**

IMPORTANT

If you have any questions or problems relating to your new Marlin, would like additional information on safe operation, or wish to order parts or accessories, just call our Customer Service Center. A Service Representative can be reached at the number listed below, between 8 A.M. and 4:30 P.M. (Eastern Time), Monday through Friday.

1-800-544-8892
(Toll Free)

Please record the firearm serial number, date of purchase and where purchased below.

Serial #: _____

Date of Purchase: _____

Purchased From: _____

In case of loss or theft, supply this information to the proper authorities.

The Fascinating History of Marlin

Written by the late William S. Brophy, Marlin's Senior Technical Manager and Official Company Historian for many years, this prodigious book details the history of the Marlin Firearms Co. and its products. The hardbound volume contains more than 600 pages and over 1000 illustrations. Must reading for anyone interested in all the models — pistols, rifles and shotguns — made by Marlin, and in the story of more than a century of firearms production in America.

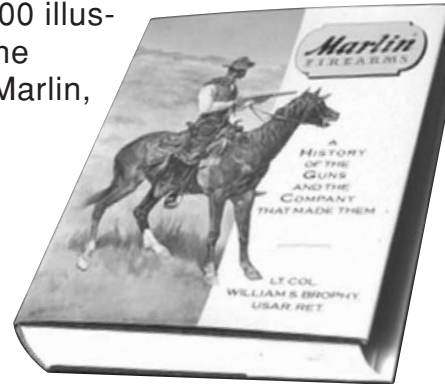

For more information, write:

Marlin Firearms Co.
Department OM
100 Kenna Drive
North Haven, CT 06473

Marlin's Guide to Gun Safety

1. Read and understand the owner's manual before using a firearm.
2. If you are unfamiliar with firearms, attend a firearms safety class taught by a certified instructor.
3. Handle every firearm as if it were loaded and ready to fire.
4. Control the muzzle, and never point a firearm at anything you don't want to shoot.
5. Keep the safety on SAFE until you are ready to shoot.
6. Unless you are hunting, carry your firearm empty, with the action open.
7. Before shooting, be sure you have an adequate backstop. All ammunition is dangerous beyond your line of sight.
8. Avoid ricochets by never shooting at water or any hard, flat surface.
9. Do not run, climb, or jump over an obstacle with a loaded firearm.
10. Do not climb into or out of a tree or tree stand with a loaded firearm.
Do not allow others to pass loaded firearms to you while in a tree stand.
11. Do not enter or ride in a motor vehicle with loaded firearms.
12. Do not lean a loaded firearm against anything.
13. Do not bump, drop or jar a loaded firearm.
14. Do not pull a firearm toward you by the muzzle.
15. Wear hearing protectors when shooting.
16. Wear impact-protective glasses when shooting, disassembling or cleaning firearms.
17. Avoid alcoholic beverages and drugs before and during shooting.
18. Use only ammunition of the correct gauge, caliber, size and bullet shape for your firearm.
19. Do not use damaged, dirty, modified, or improperly handloaded ammunition.
20. Keep the barrel and mechanism of the firearm free of obstructions.
21. Do not use a firearm that fails to function properly. Do not try to force a jammed action.
22. Be sure no one is in the path of ejecting shells or cartridges.
23. Do not interchange parts between firearms, and be sure disassembly and reassembly are correct and complete.
24. Before cleaning, be sure the chamber, action and magazine are completely unloaded.
25. Unload firearms before storing, transporting, or leaving unattended.
26. Store firearms and ammunition separately, locked and out of the reach of children.

Failure to follow these rules, or other instructions in this manual, can result in personal injury.

Printed in U.S.A.

WARNING

Children are attracted to and can operate firearms that can cause severe injuries or death.

Prevent child access by always keeping guns locked away and unloaded when not in use. If you keep a loaded firearm where a child obtains and improperly uses it, you may be fined or sent to prison.

ADVERTENCIA

A los niños los atraen las armas de fuego y las pueden hacer funcionar. Ellos pueden causarse lesiones graves y la muerte.

Evite que los niños tengan acceso a las armas de fuego guardándolas siempre con llave y descargadas cuando no las esté utilizando. Si usted tiene un arma de fuego cargada en un lugar en que un niño tiene acceso a ella y la usa indebidamente, le pueden dar una multa o enviarlo a la cárcel.

Health Warning: Discharging of firearms in poorly ventilated areas and handling ammunition may cause exposure to lead and/or lead compounds. Exposure may cause cancer, birth defects or damage to the kidney, nervous, blood forming and reproductive systems. Have adequate ventilation at all times, especially in confined areas. Wash hands thoroughly after shooting, handling ammunition, or cleaning a firearm. Do not eat or smoke during these activities.

Safety Warning: Marlin strongly recommends that you take a hunter safety course, taught by a certified instructor, before you use this firearm. Your State Fish & Game Dept. or a local gun shop can suggest courses in your area.

Safety Warning: Keep this firearm out of the reach of children, unauthorized individuals, and others unfamiliar with the safe handling of firearms.

8/04 307000

Marlin®

SELF-LOADING

Carbine

(22 L.R. only)

With Tubular Magazine

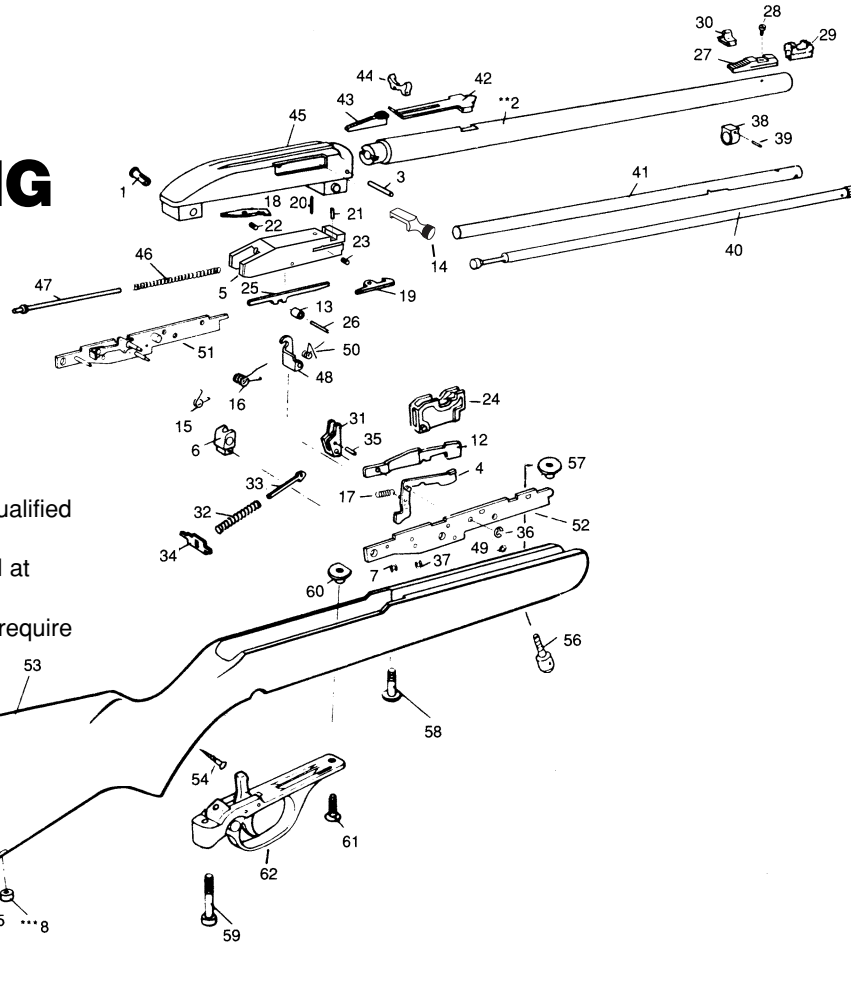

* Restricted availability—Part sent to qualified gunsmith only.

** Restricted availability—Parts installed at factory only.

*** Non-restricted availability—Part may require some final fitting, sanding or filing.

PARTS LIST

SELF-LOADING CARBINE WITH TUBULAR MAGAZINE

For parts prices, call 1-800-544-8892 (8 A.M. to 4:30 P.M., Eastern Time, Weekdays)
Be sure to mention gun serial number when ordering parts

ILL. NO.	PART NAME	ILL. NO.	PART NAME
1	Assembly Post	32	Hammer Spring
**2	Barrel	33	Hammer Strut
3	Barrel Retaining Pin	34	Hammer Strut Bridge
4	Bolt Release Lever	35	Hammer Strut Pin
5	Breech Bolt	36	Hammer Lifter Pin Ring
6	Buffer	37	Lever Retaining Ring
7	Buffer Pin Ring	38	Magazine Tube Band
***8	Bullseye	39	Magazine Tube Band Pin
***9	Buttpad	40	Magazine Tube Inside Complete
10	Buttpad Screw (2)	41	Magazine Tube Outside
11	Buttpad Spacer	42	Rear Sight Base
12	Cartridge Lifter	43	Rear Sight Elevator
13	Cartridge Lifter Roller	44	Rear Sight Folding Leaf
14	Charging Handle	**45	Receiver
15	Disconnecter Spring	46	Recoil Spring
16	Ejector Lifter Spring	47	Recoil Spring Guide
17	Extension Spring	48	Sear
18	Extractor, Left Hand	49	Sear Pin Ring
19	Extractor, Right Hand	50	Sear Spring
20	Extractor Pin, Left Hand	51	Sideplate, Left Hand
21	Extractor Pin, Right Hand	52	Sideplate, Right Hand
22	Extractor Spring, Left Hand	53	Stock
23	Extractor Spring, Right Hand	54	Stock Reinforcement Screw
24	Feedthroat	55	Swivel Stud, Rear
25	Firing Pin	56	Swivel Stud, Front
26	Firing Pin Retaining Pin	57	Swivel Stud Nut
27	Front Sight Ramp Base	58	Takedown Screw, Front
28	Front Sight Ramp Base Screw	59	Takedown Screw, Rear
29	Front Sight Ramp Hood	60	Trigger Guard Nut, Front
30	Front Sight Ramp Insert	61	Trigger Guard Screw, Front
31	Hammer	62	Trigger Guard Complete

Model 60	
ILL. NO.	PART NO.
1	407997
**2	107741
3	307897
4	507183
5	107011
6	407182
7	407178
***8	N/A
***9	320402
10	420590
11	N/A
12	307287
13	307288
14	207005
15	407196
16	307295
17	407796
18	320269
19	320369
20	320798
21	307497
22	407895
23	407895
24	407285
25	407599
26	307198
27	330144
28	320593
29	N/A
30	N/A
31	207173
32	407094
33	407179
34	307075
35	407200
36	407178
37	407252
38	220121
39	420698
40	507922
41	307923
42	220641
43	320942
44	N/A
**45	107160
46	307496
47	307071
48	307151
49	407178
50	407795
51	507004
52	207003
53	507017
54	307790
55	N/A
56	N/A
57	N/A
58	307192
59	307392
60	307491
61	307690
62	507058

Model 60DL	
ILL. NO.	PART NO.
1	407997
**2	107741
3	307897
4	507183
5	107002
6	407182
7	407178
***8	N/A
***9	320402
10	420590
11	N/A
12	307287
13	307288
14	207005
15	407196
16	307295
17	407796
18	320269
19	320369
20	320798
21	307497
22	407895
23	407895
24	407285
25	407599
26	307198
27	330144
28	320593
29	N/A
30	N/A
31	207173
32	407094
33	407179
34	307075
35	407200
36	407178
37	407252
38	220121
39	420698
40	507922
41	307923
42	220641
43	320942
44	N/A
**45	107160
46	307496
47	307071
48	307151
49	407178
50	407795
51	507004
52	207003
53	507034
54	307790
55	N/A
56	N/A
57	N/A
58	307192
59	307392
60	307491
61	307690
62	507058

Model 60C	
ILL. NO.	PART NO.
1	407997
**2	107741
3	307897
4	507183
5	107002
6	407182
7	407178
***8	N/A
***9	N/A
10	420590
11	N/A
12	307287
13	307288
14	207005
15	407196
16	307295
17	407796
18	320269
19	320369
20	320798
21	307497
22	407895
23	407895
24	407285
25	407599
26	307198
27	330144
28	320593
29	N/A
30	N/A
31	207173
32	407094
33	407179
34	307075
35	407200
36	407178
37	407252
38	220121
39	420698
40	507922
41	307923
42	220641
43	320942
44	N/A
**45	107160
46	307496
47	307071
48	307151
49	407178
50	407795
51	507004
52	207003
53	507000
54	307790
55	N/A
56	N/A
57	N/A
58	307192
59	307392
60	307491
61	307690
62	507458

Model 60SSK	
ILL. NO.	PART NO.
1	407997
**2	107006
3	307897
4	507383
5	107012
6	407182
7	407178
***8	N/A
***9	N/A
10	N/A
11	N/A
12	307287
13	307288
14	207006
15	407196
16	307295
17	407796
18	307269
19	307369
20	320798
21	307497
22	407895
23	407895
24	407285
25	407599
26	307198
27	220939
28	321091
29	316145
30	407444
31	207173
32	407094
33	407179
34	307075
35	407200
36	407178
37	407252
38	205021
39	305497
40	507022
41	307023
42	520041
43	330442
44	214142
**45	107260
46	307496
47	307071
48	307151
49	407178
50	407795
51	507004
52	207003
53	407838
54	N/A
55	N/A
56	N/A
57	N/A
58	307192
59	307392
60	307491
61	307690
62	507858

Model 60SS	
ILL. NO.	PART NO.
1	407997
**2	107000
3	307897
4	507383
5	107012
6	407182
7	407178
***8	320101
***9	407102
10	420590
11	416203
12	307287
13	307288
14	207006
15	407196
16	307295
17	407796
18	307269
19	307369
20	320798
21	307497
22	407895
23	407895
24	407285
25	407599
26	307198
27	220939
28	321091
29	320345
30	407444
31	207173
32	407094
33	407179
34	307075
35	407200
36	407178
37	407252
38	205021
39	305497
40	507022
41	307023
42	520041
43	330442
44	214142
**45	107260
46	307496
47	307071
48	307151
49	407178
50	407795
51	507004
52	207003
53	507736
54	307090
55	305490
56	430293
57	320352
58	307692
59	307792
60	307491
61	307990
62	507658

Model 60SB	
ILL. NO.	PART NO.
1	407997
**2	107001
3	307897
4	507383
5	107003
6	407182
7	407178
***8	N/A
***9	320402
10	420590
11	N/A
12	307287
13	307288
14	207006
15	407196
16	307295
17	407796
18	307269
19	307369
20	320798
21	307497
22	407895
23	407895
24	407285
25	407599
26	307198
27	220939
28	321091
29	320345
30	407444
31	207173
32	407094
33	407179
34	307075
35	407200
36	407178
37	407252
38	205021
39	305497
40	507022
41	307023
42	520041
43	330442
44	214142
**45	107260
46	307496
47	307071
48	307151
49	407178
50	407795
51	507004
52	207003
53	507017
54	307090
55	N/A
56	N/A
57	N/A
58	307692
59	307792
60	307491
61	307990
62	507658